

# ALUMINIUM GATE - POST MOUNT INSTRUCTIONS

5 PM CUT OFF TIME  
NEXT DAY DELIVERY  
TRADE BULK DISCOUNT.

There are 3 methods of installation. Refer to the correct page for specific details. Page 1 - Post Mount Page 2 - Wall mount using 2 x Wall Brackets Page 3 - Wall Mount using 1 Wall bracket (topside) & 1 floor bracket

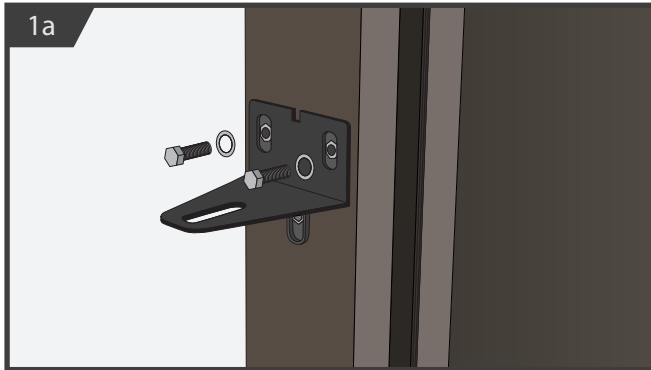

Install the top L-bracket hinge to the post using the 3 bolts provided.

Ensure the bracket is installed in the correct orientation on the hinge post, following the normal closed gate position.

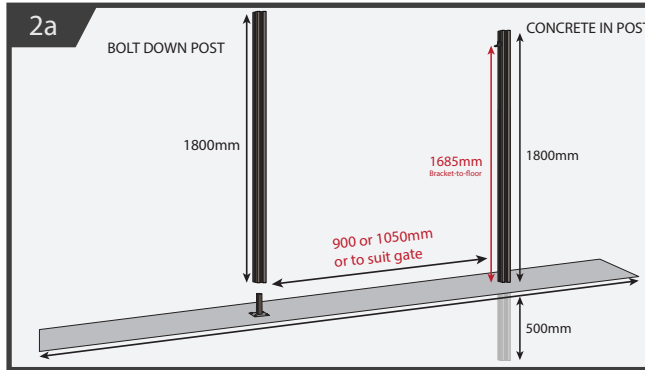

Install the 1800mm posts at the required spacing for your selected gate size, allowing either a 900mm or 1050mm clear opening between the posts.

NOTE: Ensure the base is flat, smooth, and level to allow secure fixing of the gate base hinge.

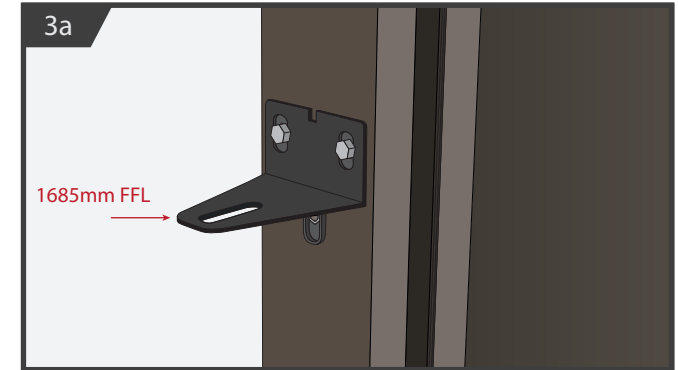

If concreting in or root-mounting posts, ensure the top hinge is positioned 1685mm above finished floor level (FFL), and ensure the post is square and level.

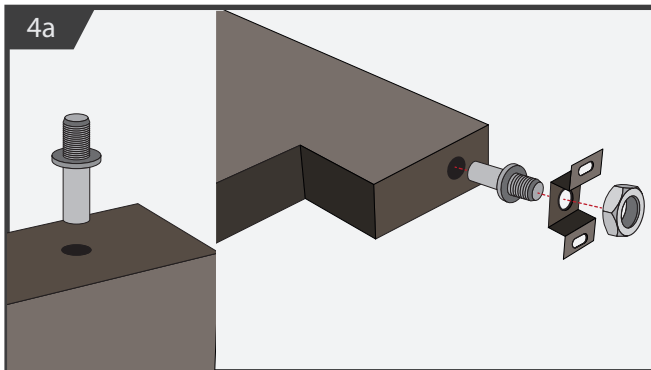

Insert the hinge bolt assembly into the bottom of the gate along with the floor plate bracket.

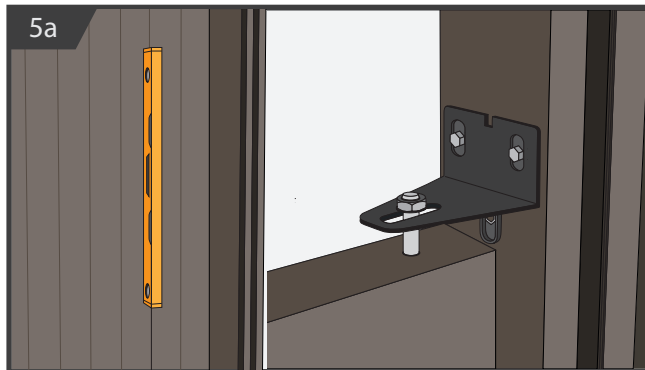

Lift the gate into position and hand-tighten the top bolt into the CENTRE of the top bracket.

It is important to fix this in the centre of the bracket, as this allows adjustment in both directions later if required.

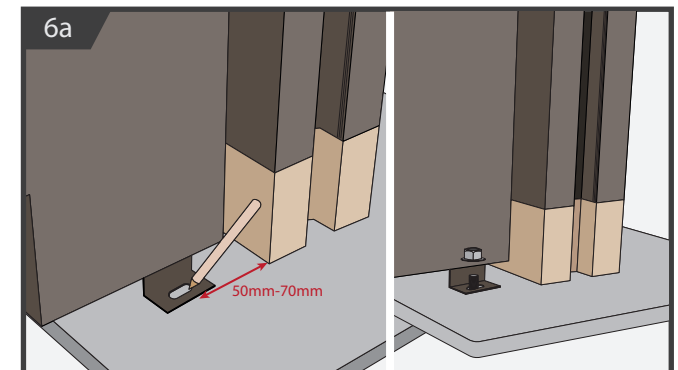

Check the gate is level and square, then mark the CENTRE position of the ground bracket.

Drill the holes and fix using suitable fixings.

Hand-tighten only at this stage, as further adjustment may be required later.

# ALUMINIUM GATE - 2 X WALL BRACKETS

5 PM CUT OFF TIME  
NEXT DAY DELIVERY  
TRADE BULK DISCOUNT.

There are 3 methods of installation. Refer to the correct page for specific details. Page 1 - Post Mount Page 2 - Wall mount using 2 x Wall Brackets Page 3 - Wall Mount using 1 Wall bracket (topside) & 1 floor bracket

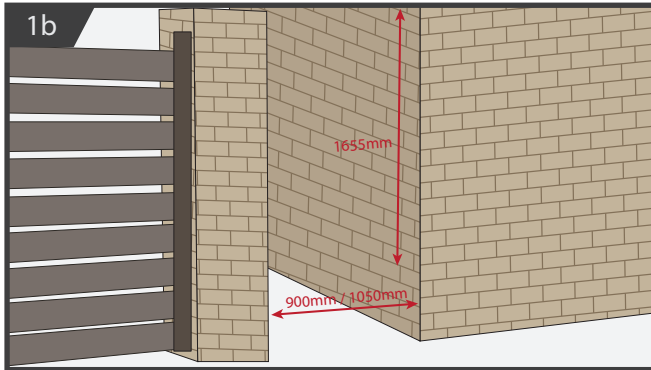

For wall mounting using 2 wall brackets, the distance between the upper and lower bracket centres should be 1655mm.

Ensure the wall is flat and level before installation, and ensure the opening is suitable for either a 900mm or 1050mm gate.

If your opening size differs, consider additional 75mm post or 15mm/30mm expansion panels.

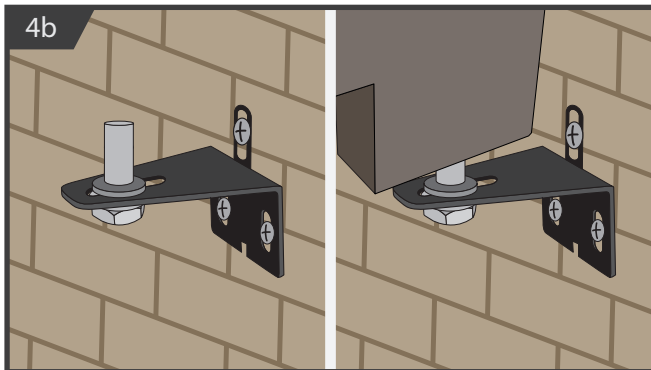

You may require an additional person to assist with this step.

Carefully lift the gate into position and check it is square and level using a spirit level.

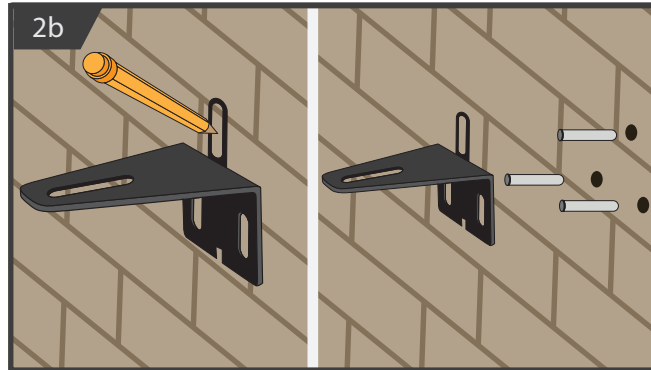

Mark, drill, and plug the 3 fixing holes for the bottom bracket as shown, ensuring the hinge carrier L-bracket is level and flat.

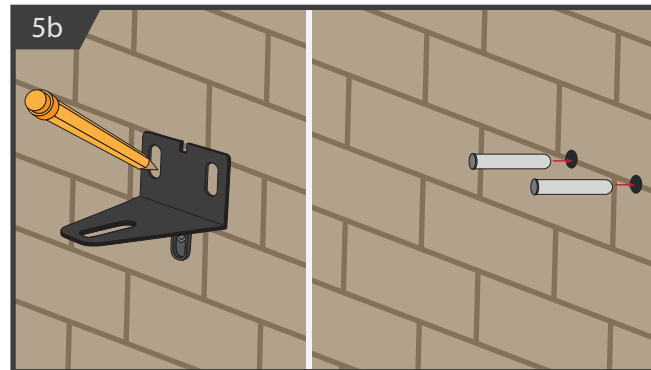

If you have not already done so, mark the top 2 fixing holes as shown. These should be positioned 1655mm from the lower bracket.

Drill and plug the holes as required.

Do not fix the bracket to the wall at this stage.

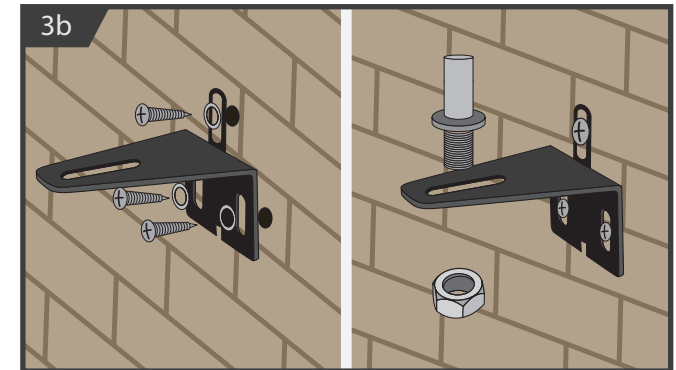

Fix the bracket using suitable wall fixings.

Then assemble the hinge bolt and nut into position.

For best practice, keep the hinge bolt in the centre of the bracket, as this allows for later adjustment.

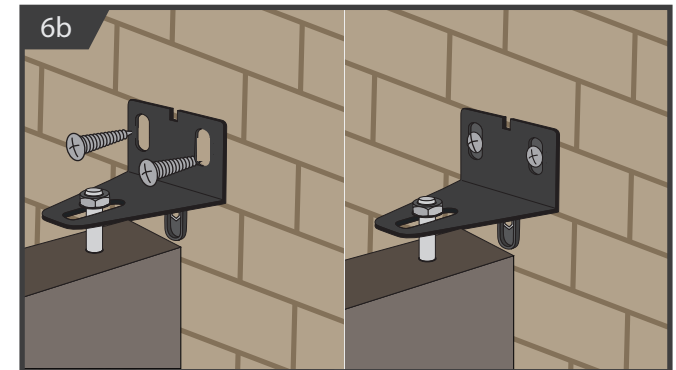

Fix the bracket hinge to the gate using the hinge bolt and nut.

For best practice, keep the hinge bolt in the centre of the bracket to allow for later adjustment.

Lift the gate into position and secure it to the wall using the 2 fixing holes prepared in the previous step.

# ALUMINIUM GATE - TOP WALL BRACKET + FLOOR BRACKET

5 PM CUT OFF TIME  
NEXT DAY DELIVERY  
TRADE BULK DISCOUNT.

There are 3 methods of installation. Refer to the correct page for specific details. Page 1 - Post Mount Page 2 - Wall mount using 2 x Wall Brackets Page 3 - Wall Mount using 1 Wall bracket (topside) & 1 floor bracket

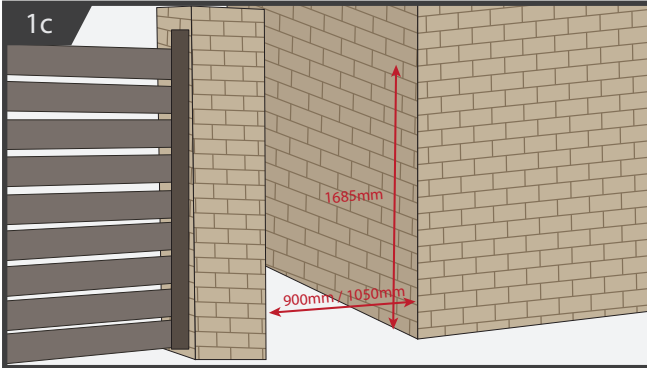

For wall mounting using 1 wall bracket and 1 floor bracket, the distance between the upper bracket and finished floor level should be 1685mm.

Ensure the wall is flat and level before installation, and ensure the opening is suitable for either a 900mm or 1050mm gate.

If your opening size differs, consider additional 75mm post or 15mm/30mm expansion panels.

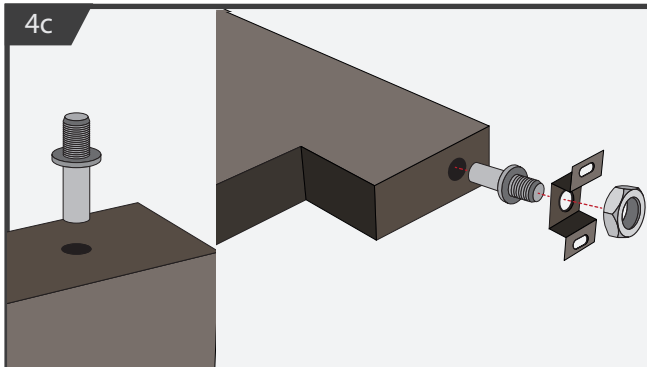

Assemble the floor bracket with the hinge bolt and nut as shown.

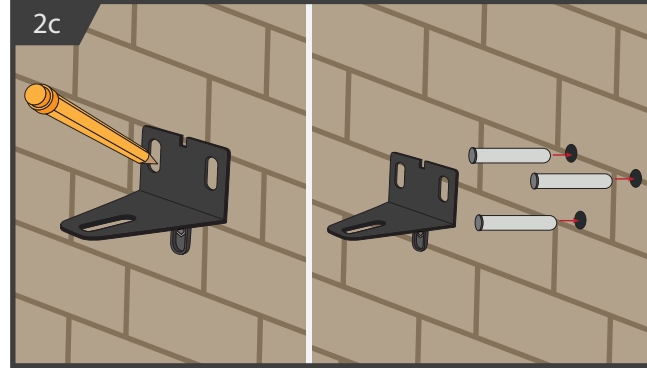

Mark, drill, and plug the 3 fixing holes for the top bracket as shown, ensuring the hinge carrier L-bracket is level, flat, and positioned 1685mm above finished floor level.

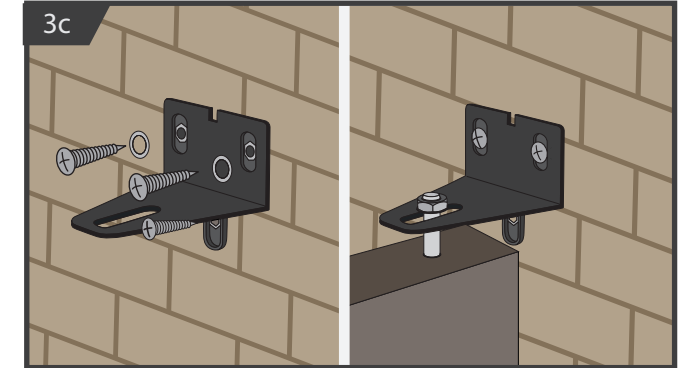

Fix the upper bracket using suitable wall fixings.

Then assemble the hinge bolt and nut into position.

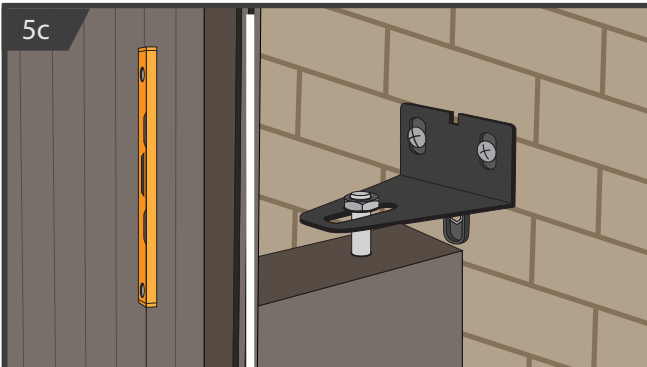

Lift the gate into position on the upper bracket.

You may need to angle the gate slightly to guide the floor bracket into position correctly.

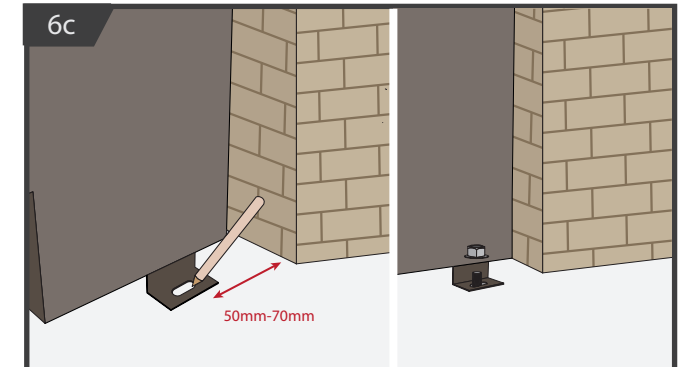

Level the gate and mark the fixing hole positions for the ground bracket. For best practice, position the hinge bolt in the centre of the bracket to allow for later adjustment. Drill and fix into position using suitable fixings.

Hand-tighten only at this stage, as further adjustment may be required later.

# ALUMINIUM GATE - LOCK, HANDLE & KEEP

5 PM CUT OFF TIME  
NEXT DAY DELIVERY  
TRADE BULK DISCOUNT.

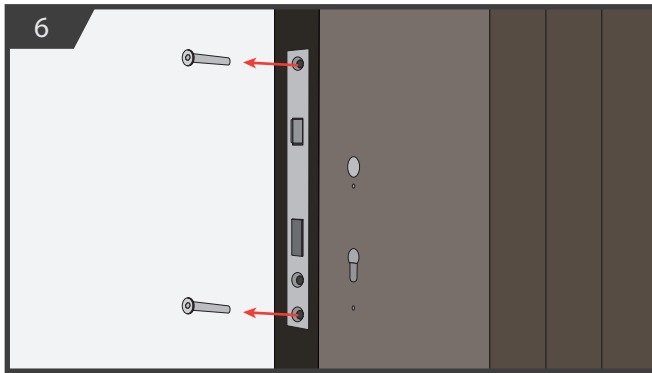

The lock cassette is universal, and the latch direction can be reversed by removing the 2 sashlock screws as shown.

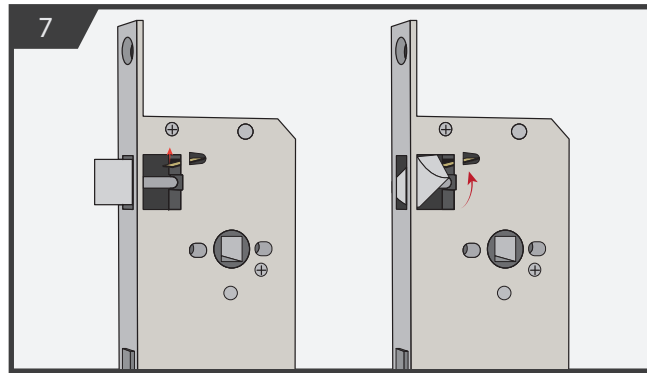

Lift the tab and push the latch fully into the cassette.

Rotate to reverse the handing of the gate.

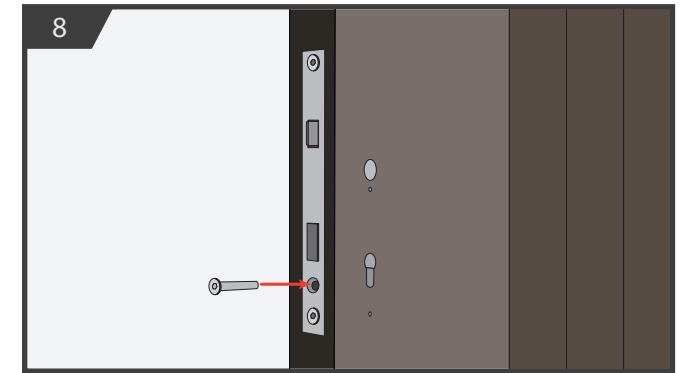

Re-insert the sashlock as shown in Step 6.

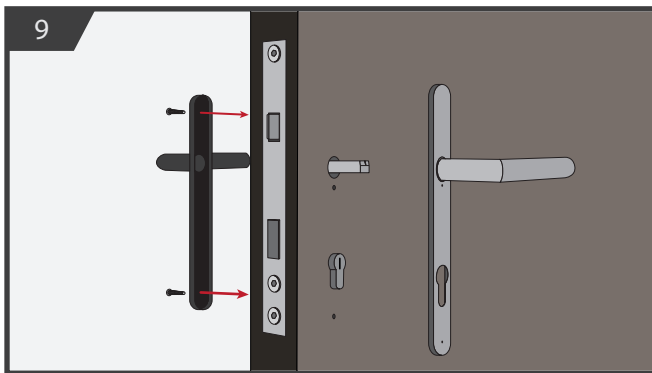

Fit the spindle and euro cylinder.

Set the handle to the correct orientation by rotating it to suit your installation.

Fix the handle to the gate using the 2 screws provided. NOTE: The handle with the visible screw heads should be installed on the internal side of the gate for security purposes.

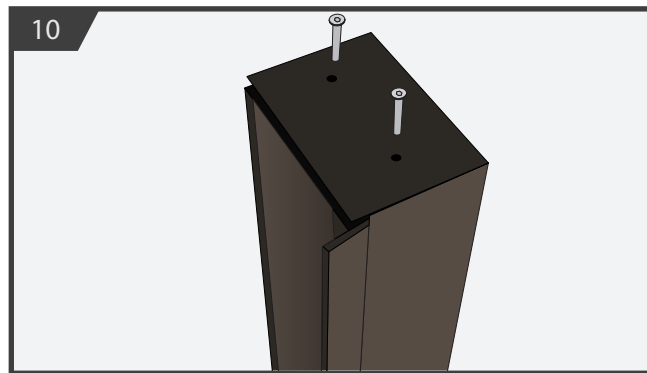

Take the locking post and fix the end cap to the bottom of the locking channel using the 2 screws provided.

Do not fit the top cap at this stage.

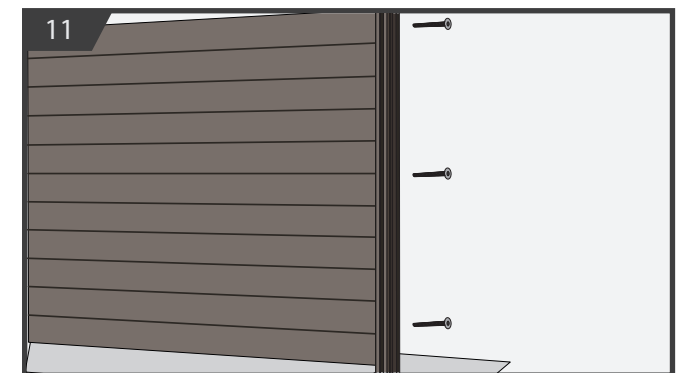

Fit the locking/latching channel into position. This can be fixed directly to an adjacent wall or post using suitable fixings.

NOTE: The L-channel stopper should be installed on the outside of the gate to prevent the gate from opening beyond 180°.

This can be removed if not required & you wish to open the gate both inwards & outwards.

# ALUMINIUM GATE - LOCK, HANDLE & KEEP

5 PM CUT OFF TIME  
NEXT DAY DELIVERY  
TRADE BULK DISCOUNT.

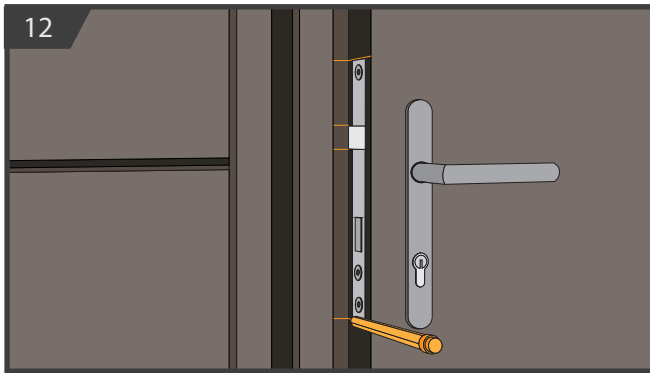

Close the gate and mark the latch position on the lock keep channel.

Use the locking plate provided to align with the pencil marks, then mark the top and bottom positions of the lock plate.

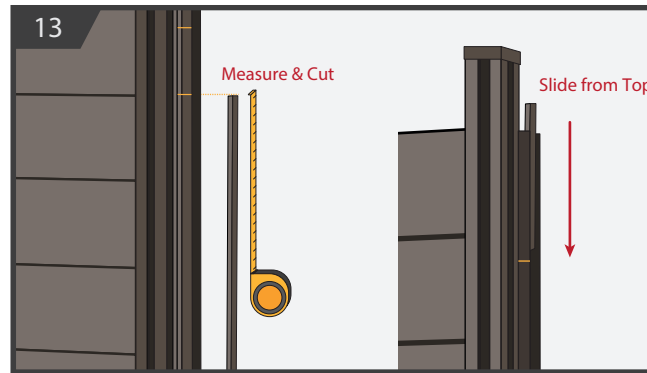

Measure from the bottom of the channel to the bottom of the locking plate.

Cut the channel to suit and insert into position.

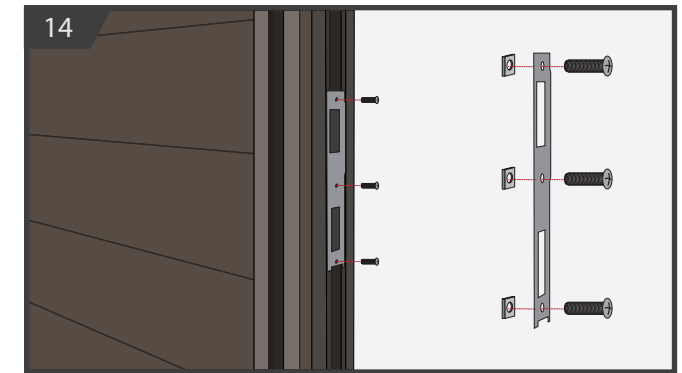

Loosely fit the 3 bolts and square nuts to the locking plate. Slide the assembly into position from the top and tighten.

NOTE: Ensure the latch holes align with the pencil marks from the previous step to allow the gate to latch and lock correctly.

Test and adjust the height if required.

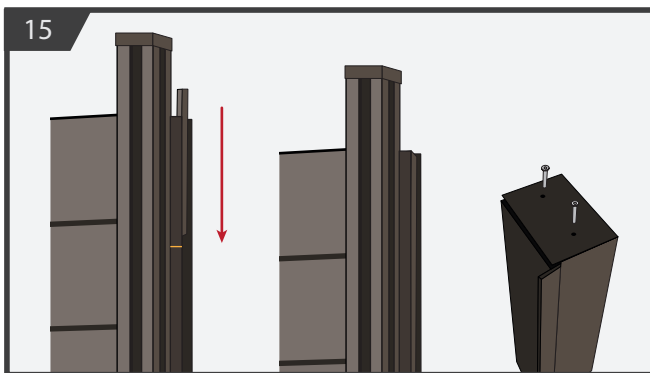

Measure and cut the top channel insert.

Insert into position and fix the cover plate to the exposed top end of the channel.

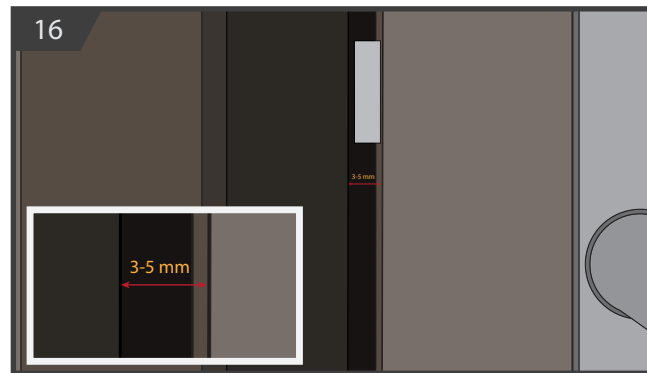

Now your gate is installed, test the latch and lock.

The gate should close smoothly against the stop L-channel and latch and lock correctly.

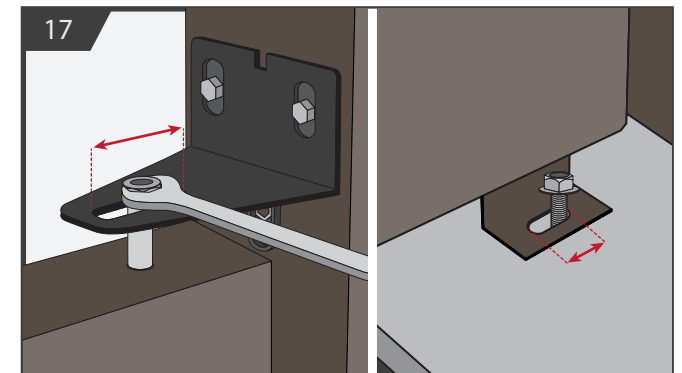

If the hinge bolts were fixed in the centre of the hinge brackets, the gate can be adjusted approximately 2-3mm in either direction.

Adjust by loosening the hinge bolts.

Once the optimum position is achieved, fully tighten using a spanner.

# ALUMINIUM GATE - POST MOUNT INSTRUCTIONS

5 PM CUT OFF TIME  
NEXT DAY DELIVERY  
TRADE BULK DISCOUNT

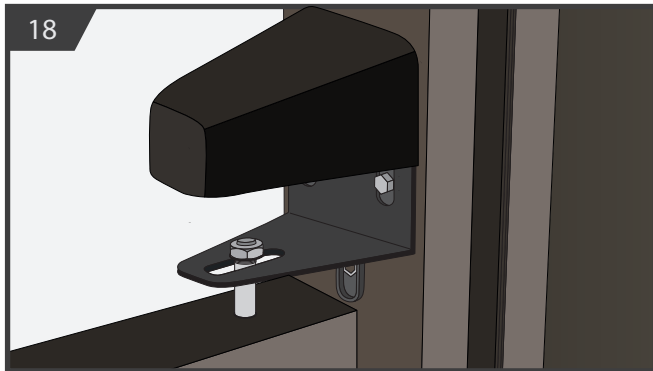

Fit the end caps to complete the installation.

02

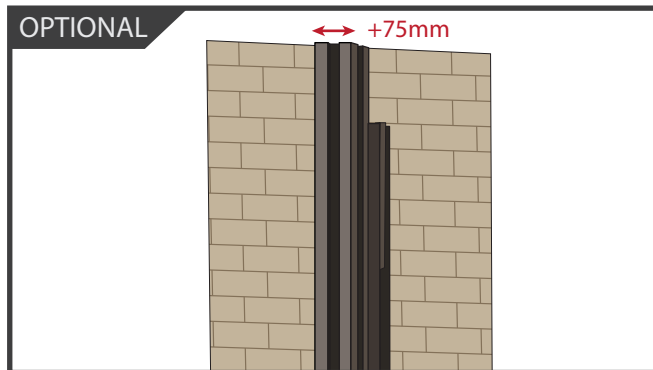

Optional - If your opening size does not suit a standard stock gate size, consider using an additional 75mm post.

This can be fixed to the wall, with the locking channel then fixed to the post to increase the opening size.

Example:  
900mm gate + 75mm post = 975mm opening.

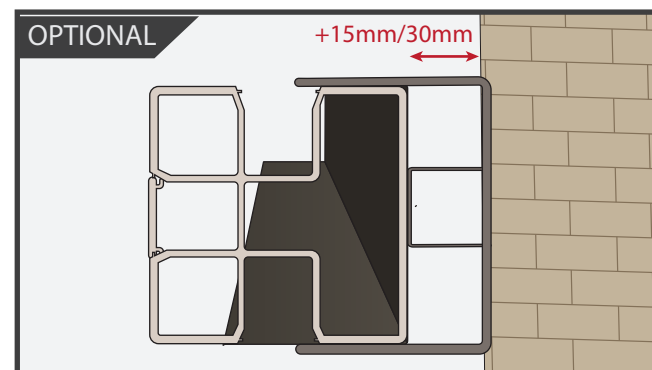

Optional - If additional adjustment is still required, optional 15mm and 30mm post expansion channels are available.

These fix to the wall first and allow the post to be mounted onto them, increasing the overall opening width by either 15mm or 30mm.